

## Worm gearboxes and geared motors in stainless steel

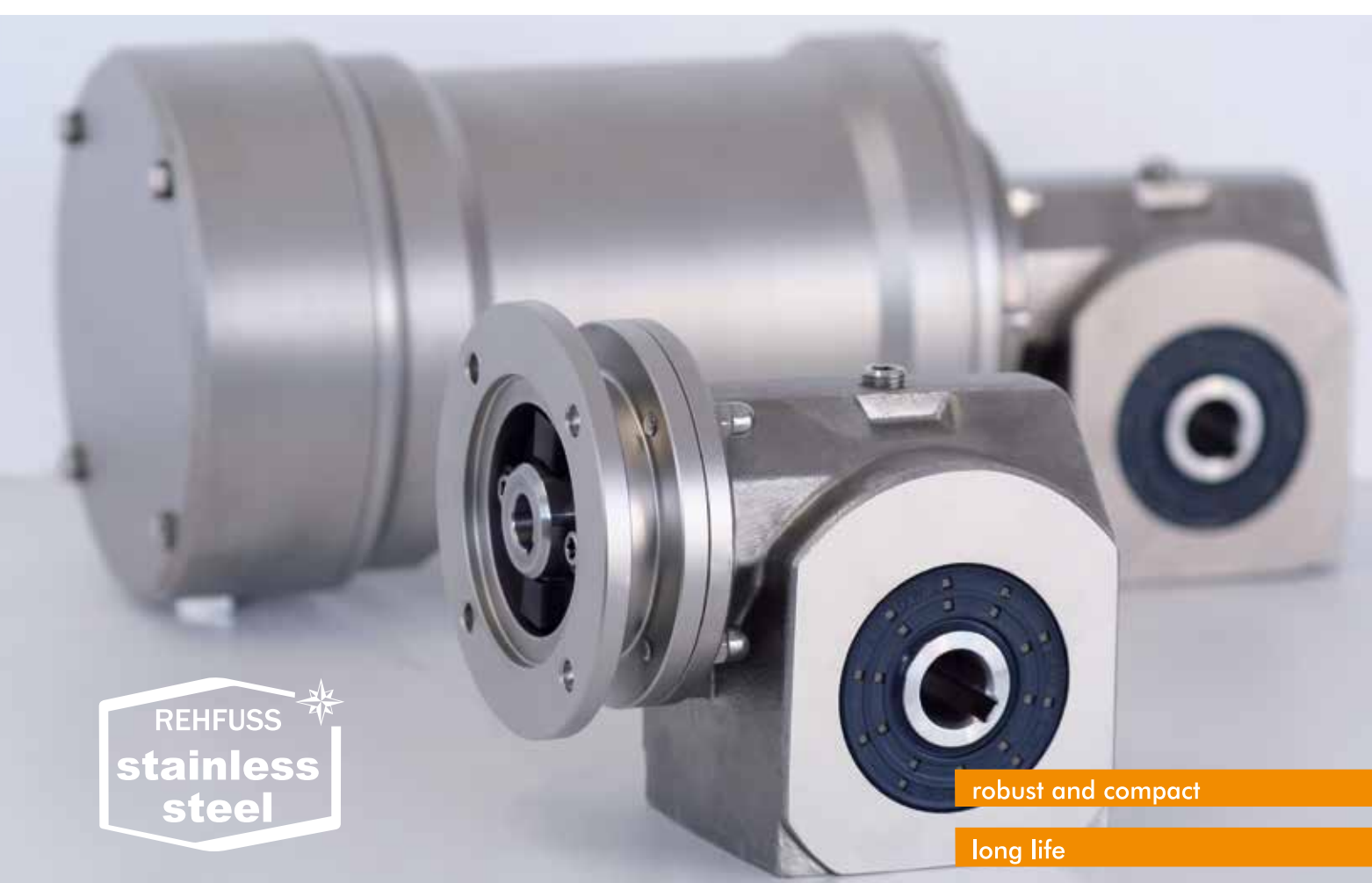

REHFUSS  
stainless  
steel

robust and compact

long life

highest efficiency

housing made of 1.4308

shaft made of 1.4301

life-time lubrication

NOTOX - Edition

various installation positions

stainless steel motors

IEC coupling

customized solutions

### A new definition of quality – Stainless steel

When using production devices and machines in some industrial sectors, hygienic aspects, demands for easy cleaning as well as demands for the quality on the materials and components used are very important. Examples for such applications can be found particularly in the food industry; the chemical or petrochemical industry.

Rehfuß offers with the SMN-series, the worm gearbox series made completely from stainless steel, an optimum solution for all applications where cleanness, hygiene and increased demands for material quality are important. Dirt cannot deposit on the absolutely smooth surface. These drives show a very high resistance against aggressive substances as well.



## Smooth Body 3-phase motor SB71



DELTA ELEKTRONIK A/S

Delta Elektronik A/S  
Husby Allé 17  
2630 Taastrup  
Telefon 43 71 80 88  
Telefax 43 71 80 38  
E-mail salg@deltaelektronik.dk  
Website www.deltaelektronik.dk

01.2017 - Synregi 70 27 90 03

DELTA ELEKTRONIK A/S

# EFFICIENT, POWERFUL AND SMOOTH SURFACE

Smooth body motor SB71  
4-pole asynchronous 3-phase motor

**ELECTROCHEMICALLY  
POLISHED SURFACE**  
Optimum surface quality for  
reduced germ formation.

**INTEGRATED TERMINAL BOARD**  
Easy and secure mains connection.



**RADIAL CABLE ENTRY**  
Position of cable entry can be determined  
flexibly 4 x 90° during installation.

**LASER CUT NAMEPLATE**  
Resistant against detergents and disinfectants.

**HIGH PROTECTION CLASS**  
IP66 (optional IP69K) for  
wash-down-applications.

**SUITABLE FOR FREQUENCY INVERTER**  
Motor winding, insulation system are  
optimized for mains or frequency  
operation. Efficiency class IE3.

**SMOOTH HOUSING SURFACE**  
Smooth, round inline-housing for  
easy and thoroughly cleaning.

**OPTIMIZED SEALING MATERIALS**  
Can be individually adapted to operation conditions.

Picture shows version SBH with options

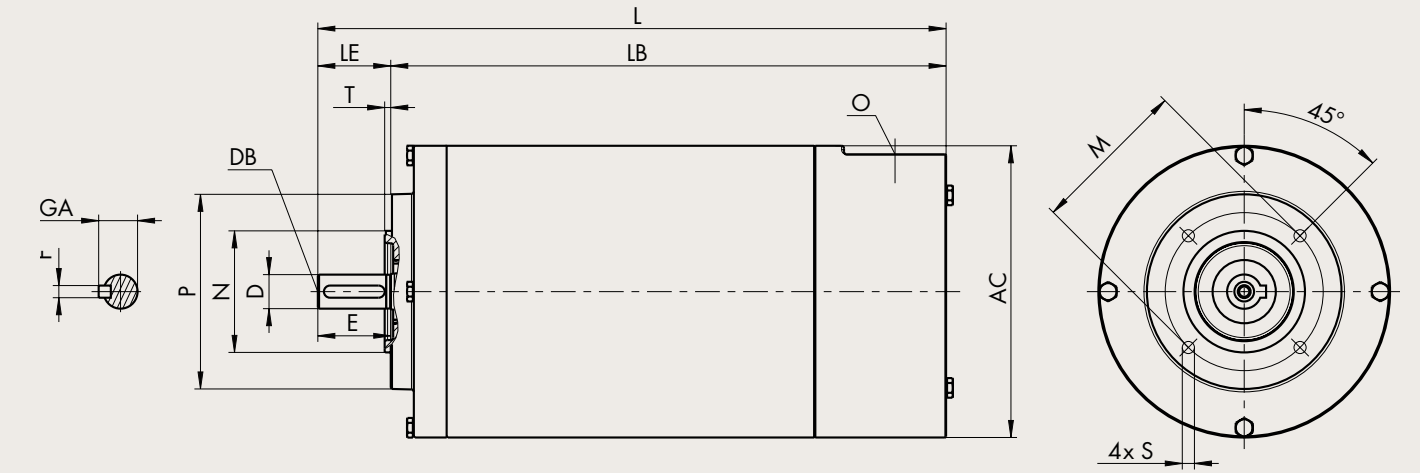

Type	kW	1/min	A (400 V)	Flange and housing						Shaft AS								
				Pj6	N	M	T	S	AC	L	LB	O	D k6	E	LE	GA	F	DB
SBA SBE SBH 71S/4	0,2	1.400	0,64	80	50	65	2,5	M5	120	260	230	M20 x 1,5	14	30	30	16	5	M5
SBA SBE SBH 71L/4	0,25	1.440	0,9	90	60	75	2,5	M5										
SBA SBE SBH 71L/4a	0,37	1.390	1,08	90	60	75	2,5	M5										

SBA = Aluminium with coating | SBE = Stainless steel | SBH = Stainless steel in hygienic-design

Technical specifications:

## Worm gearboxes SMN-series

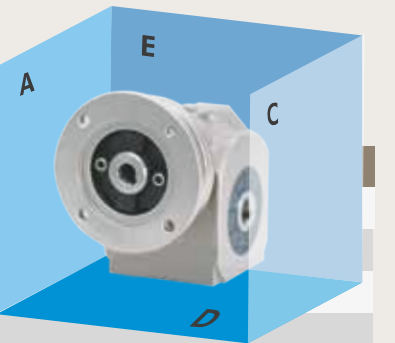

Type	SMN021	SMN031	SMN051						
Centre distance	a mm	33	40	63					
Reduction	i min - max	5 - 75	6,75 - 80	6 - 70					
Output torque	M max Nm	26	50	180					
Input power	Pe max kW	0,55	1,1	2,2					
Motor type	Standard	63	71	80					
Hollow shaft	Ø mm	15	20	25 / 30					
Executions	HG	HZ	HU	HG	HZ	HU	HG	HZ	HU
Mounting face	A	•	•	•	•	•	•	•	•
	C	•	•	•	•	•	•	•	•
	D	•	•	•	•	•	•	•	•
	E	•	•	•	•	•	•	•	•

Standard:

- Housing made of 1.4308 / 1.4301
- Hollow shaft made of 1.4301
- Life-time lubrication
- IEC standard motor coupling

Options:

- Flange version
- Solid shaft
- Stainless steel motor made of 1.4301
- NOTOX - lubrication

## THE SMOOTH ONE FROM REHFUSS

### OPTIONS (excerpt)



Cable gland  
Stainless steel



Cable gland  
Stainless steel hygienic  
EHEDG certificated



Combination with gearboxes of the  
REHFUSS gearbox modular system

### VERSIONS



**SBA**  
Smooth body motor  
Aluminium with coating



**SBE**  
Smooth body motor  
Stainless steel



**SBH**  
Smooth body motor  
Stainless steel in hygienic-design